

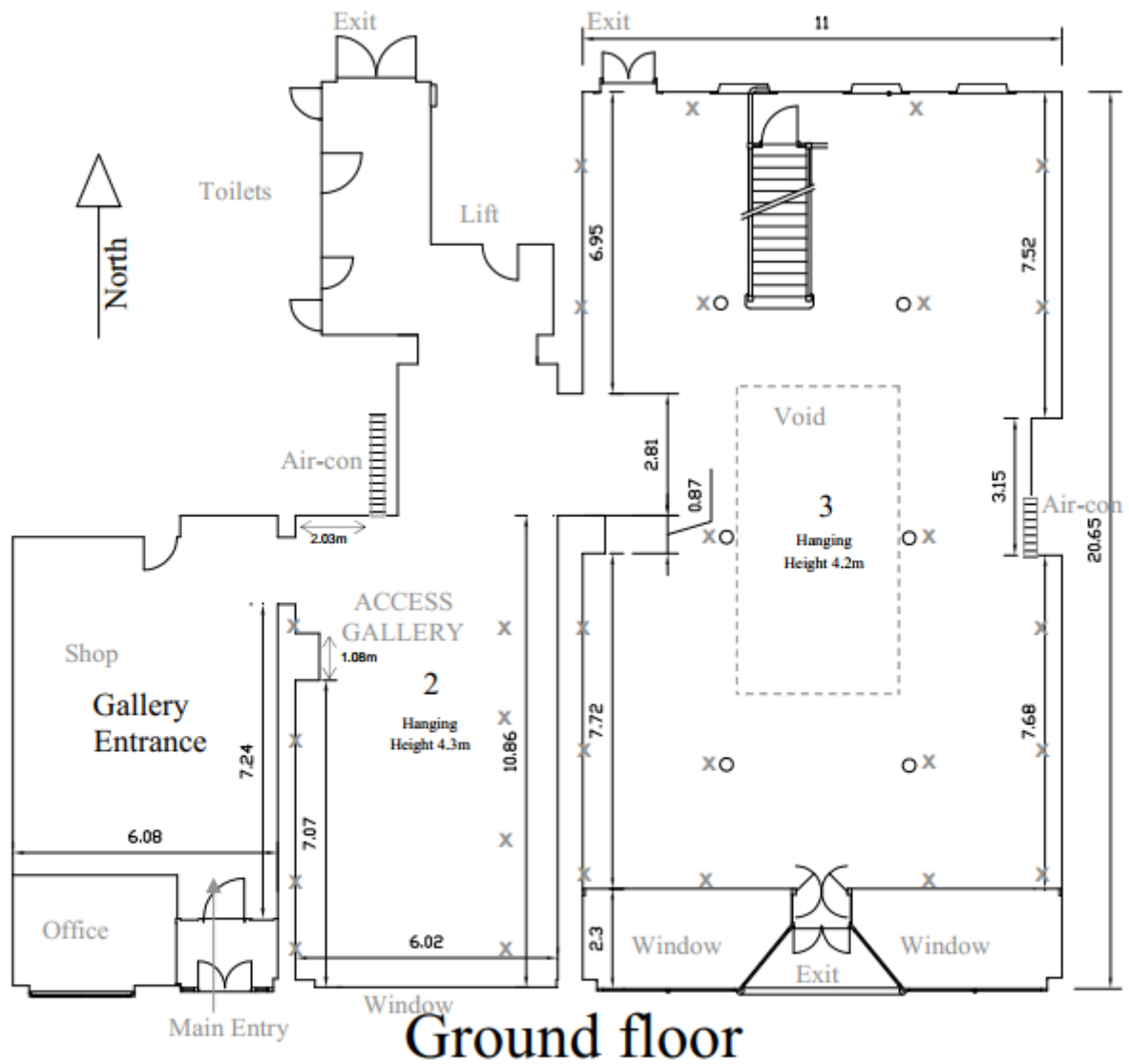

Access Gallery

Touring Gallery



## Ground floor

### Technical Notes

- No fixing to walls - walls are pug and rock construction
- Hanging system - woven steel wire with adjustable hooks
- Double power points = x
- Access via rear of building



Gallery 1

Gallery 2

Gallery 4

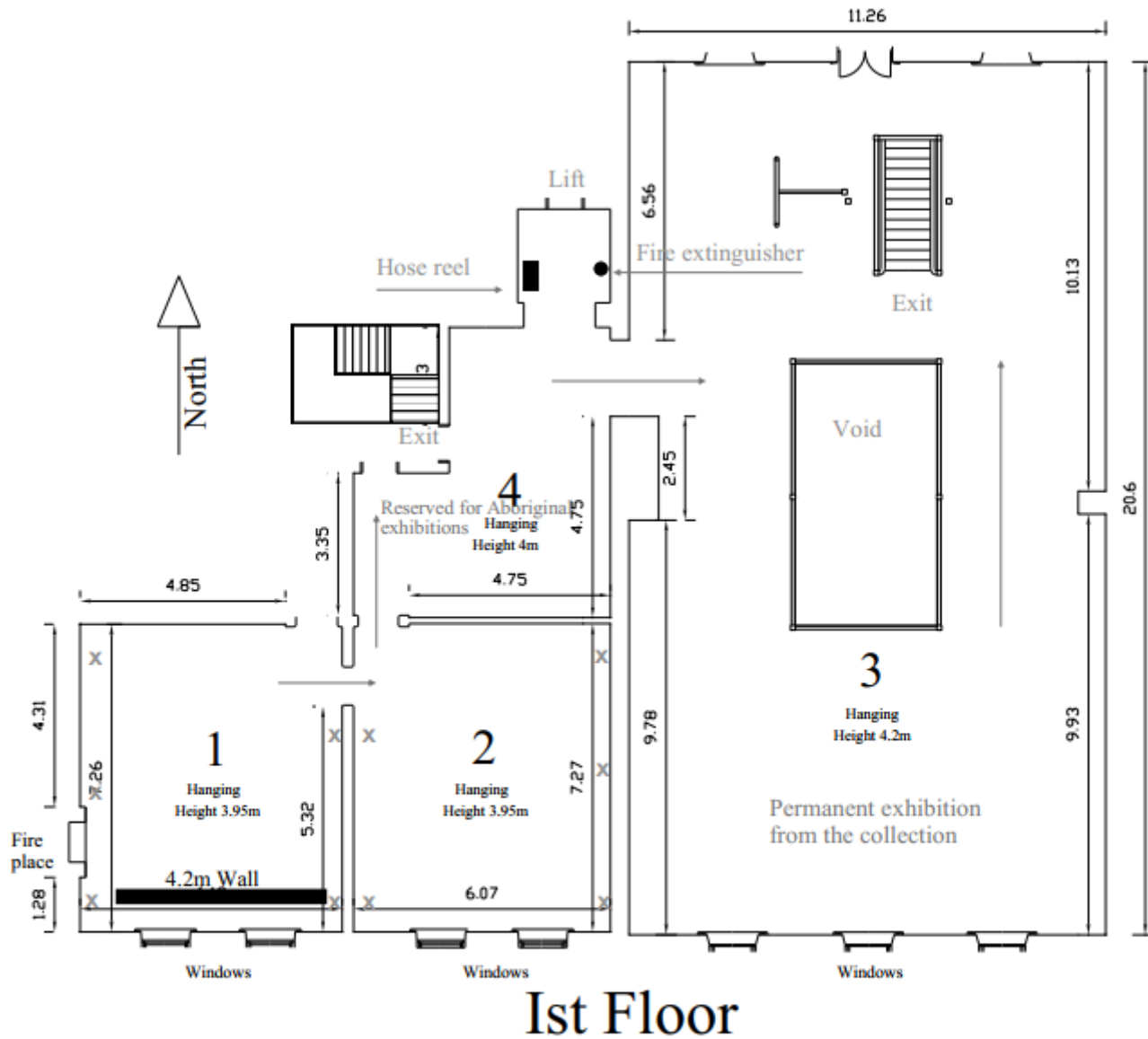

## Ist Floor

- No fixing to walls - walls are pug and rock construction
- Hanging system - woven steel wire with adjustable hooks
- Double power points = x
- Access via lift